

PARTS LIST

KEY QTY DESCRIPTION			KEY QTY DESCRIPTION			KEY QTY DESCRIPTION		
1	2	Sled Base	4	2	Steel Bar	7	4	Seat Screw (Longer) + Washer
2	1	Seat Cushion	5	4	Backrest Screw (Short)			
3	1	Seat Plastic Cover	6	1	Back	8	4	Glide

STEP 1.

Screw-in Seat Screws
not yet tighten.

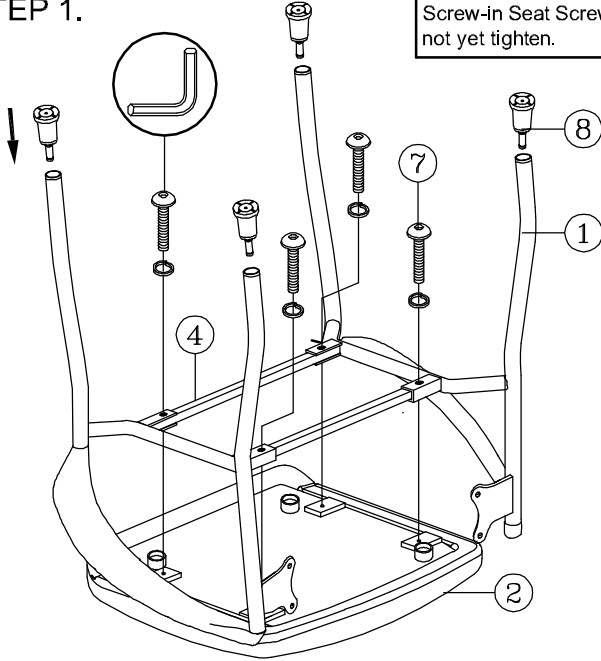

STEP 2.

Tightly screw-in
Backrest Screw
into the holes.
Then securely
tighten up Seat
Screws.

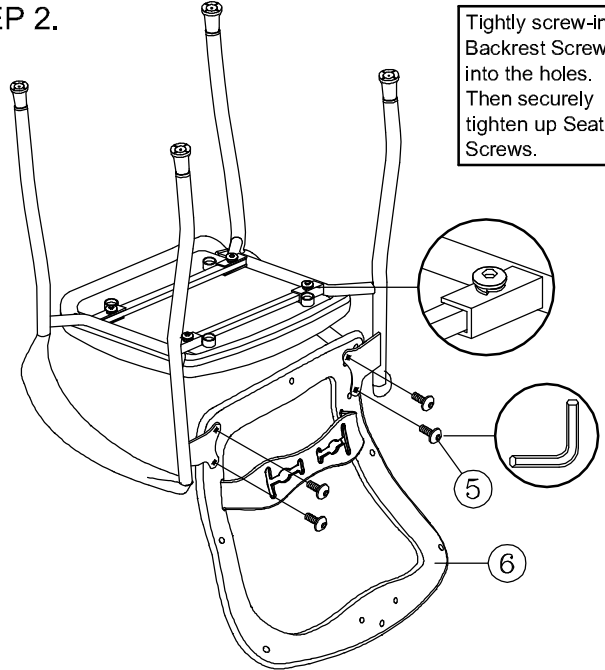

STEP 3.

Push hard until you hear
the click sound in which
the plastic bar is lock in.

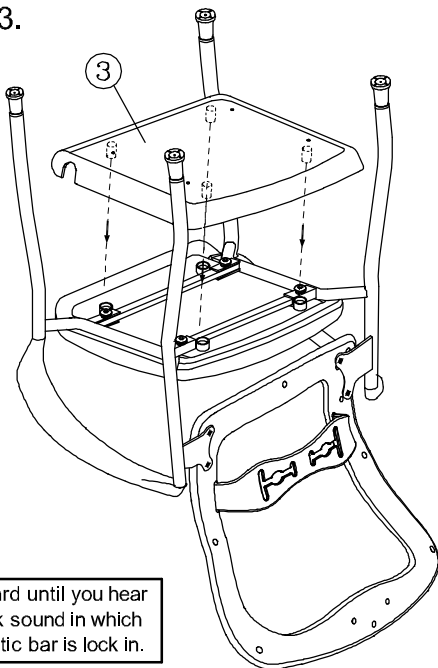

Allen Wrench

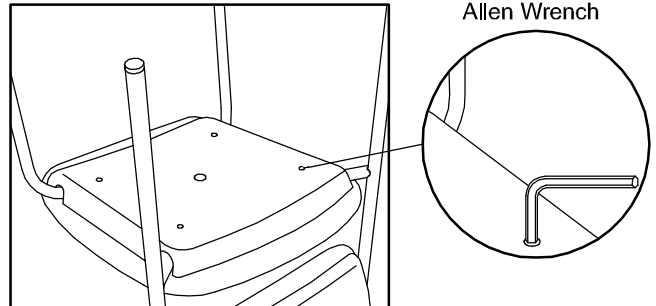

PREVENTIVE MAINTENANCE AND WARNING !

- From time to time , check to make sure screws are securely tightened.
- ◇ Holes on PP shell are for convenient checking.

PREVENTIVE MAINTENANCE AND WARNING!

- USE THIS PRODUCT ONLY FOR SEATING ONE PERSON AT A TIME.
- DO NOT USE THIS CHAIR AS A STEP STOOL / LADDER.
- DO NOT SIT ON ANY PART OF THE CHAIR EXCEPT THE SEAT.
- DO NOT USE CHAIR ON UNEVEN FLOOR SURFACES.
- DO NOT USE CHAIR UNLESS ALL BOLTS, SCREWS AND KNOBS ARE TIGHTENED.
- **EVERY SIX MONTHS, PLEASE MAKE SURE ALL BOLTS, SCREWS AND KNOBS ARE FULLY TIGHTENED TO ENSURE STABILITY.**
- IF ANY PARTS ARE MISSING, BROKEN, DAMAGED OR WORN, STOP USE OF THE PRODUCT UNTIL REPAIRS ARE MADE USING FACTORY AUTHORIZED PARTS.
- DISPOSE OF PACKAGING PROPERLY. PLASTIC BAG IS NOT A TOY.
- DO NOT USE PLASTIC BAG AS HEAD COVERING - IT MAY CAUSE SUFFOCATION.
- FAILURE TO FOLLOW THESE WARNINGS COULD RESULT IN SERIOUS INJURY.
- NOTE:SOME SCREWS MAY BE PREASSEMBLED.
- IF PREASSEMBLED, IGNORE ASSEMBLY INSTRUCTIONS.

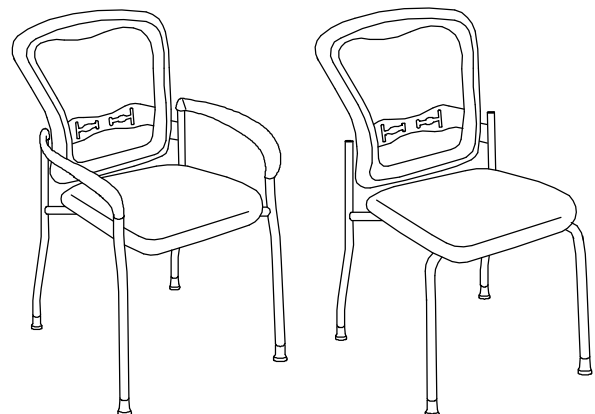

7804TG / 7804SG / 7809TG